

- SECTION 38/278 AGREEMENT COLOURING KEY**
 The prime purpose of this drawing is to show in colour the extent of the existing and proposed highway (Section 278/38) which is subject to various works. Full construction and technical details are shown in supporting documents, specifications etc., on the latest revisions of the drawings deemed to form part of the Section 38/278 Agreement, provided they have been subject to formal technical approval, in writing by the Local Highway Authority. Under NRSWA Act 1991 all covers in highway must have a minimum spacing (clearance) of 200mm to other coverworks/signage and within the carriageway of 300mm.
- Section 38 Footway construction. Area (204sqm)
For details see drawing 601-Highway Construction Details
 - Section 38 Vehicle crossover construction. Area (40sqm)
For details see drawing 603-Vehicle Crossover Construction Details
 - Section 38 Highway construction. Porous Asphalt Area (306sqm)
For details see drawing 601-Highway Construction Details
 - Section 38 Tactile Paving. Area (11sqm)
For details see drawing 604-Tactile Paving Construction Details
 - Section 278 Footway construction. Area (107sqm)
For details see drawing 601-Highway Construction Details
 - Section 278 Highway construction. Non Permeable Area (31sqm)
For details see drawing 601-Highway Construction Details
 - Section 278 Resurfacing. Area (71sqm)
For details see drawing 603-Vehicle Crossover Construction Details
 - Section 538/278 Half Believed HB2 kerbs 125mm Upstand
For details see drawing 602-Kerb Laying Construction Details
 - Section 538/278 Flat top edging EP kerbs
For details see drawing 602-Kerb Laying Construction Details
 - Section 538/278 Bullnose BN2 kerbs 6mm Upstand
For details see drawing 602-Kerb Laying Construction Details
 - Section 538/278 Transition kerbs 125mm to 6mm (Left HB2 to BN2, Right BN2 to HB2)
For details see drawing 602-Kerb Laying Construction Details

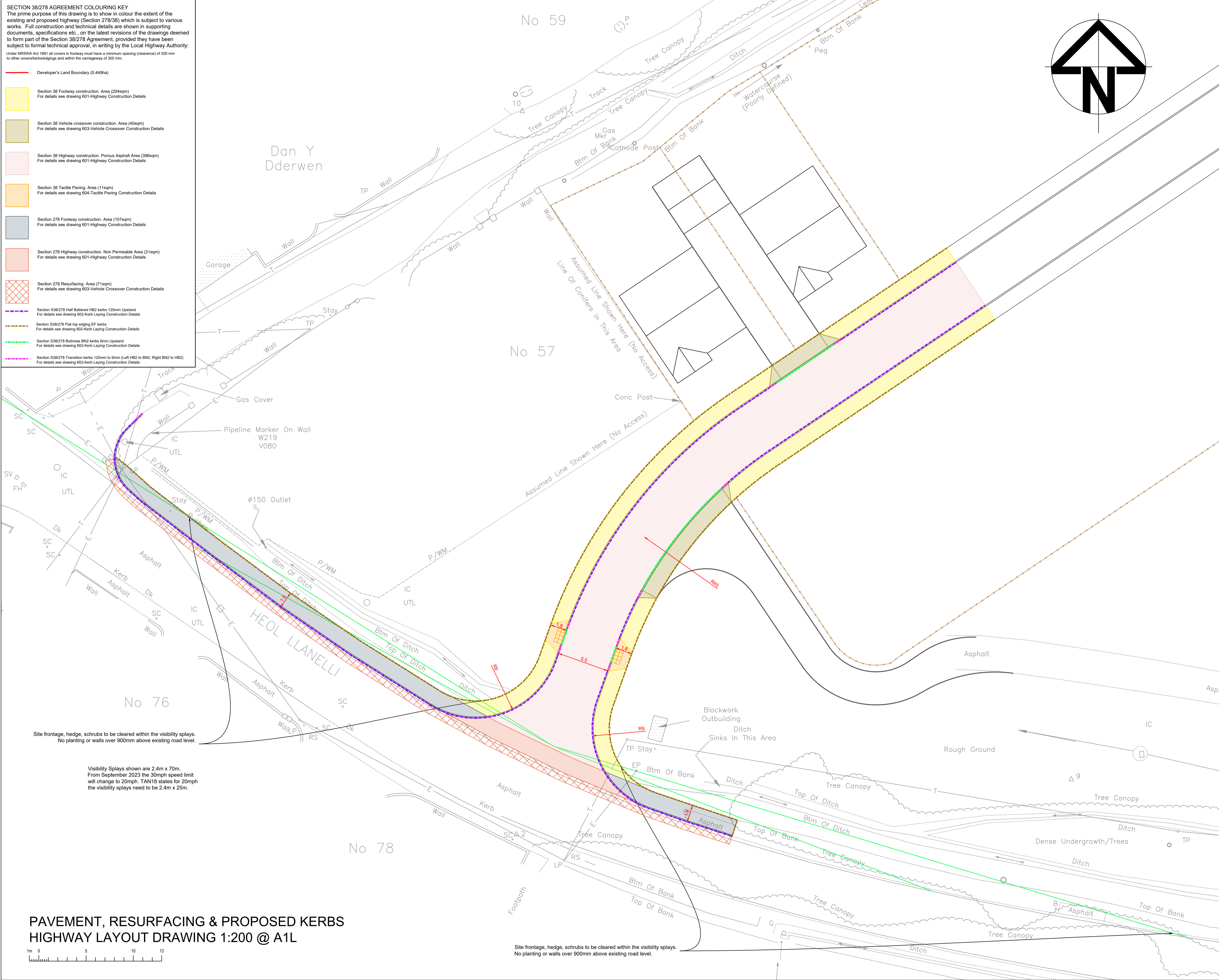

- General Notes
1. ALL DIMENSIONS ARE INDICATIVE AND IN METRES UNLESS NOTED OTHERWISE.
 2. DO NOT SCALE THIS DRAWING. USE FIGURED DIMENSIONS ONLY.
 3. ALL LEVELS ARE IN METRES ABOVE ORDNANCE DATUM (AOD) BASED ON THE TOPOGRAPHICAL SURVEY DRAWING SUPPLIED BY THE CLIENT.
 4. ANY DISCREPANCIES TO BE REPORTED TO THE ENGINEER.
 5. THIS DRAWING IS TO BE READ IN CONJUNCTION WITH ALL OTHER RELEVANT ARCHITECTS AND ENGINEERS DRAWINGS AND SPECIFICATIONS.
 6. THE SPECIFICATION IN ALL ASPECTS SHALL BE IN ACCORDANCE WITH THE CURRENT RESIDENTIAL DESIGN GUIDE AND SPECIFICATION IN FORCE WITHIN THE COUNTY AT THE TIME OF CONSTRUCTION.
 7. COPYRIGHT OF THIS DRAWING IS RETAINED BY THE ENGINEER AND IT MUST NOT BE REPRODUCED IN WHOLE OR PART WITHOUT WRITTEN CONSENT.
 8. CONFLICTING INFORMATION SHOWN ON THE DESIGNERS DRAWINGS OR DISCREPANCIES BETWEEN THE INFORMATION GIVEN BY THE ENGINEER AND THAT PROVIDED BY OTHERS MUST BE REFERRED TO THE DESIGN ENGINEER BEFORE WORKS COMMENCE.
 9. TEMPORARY WORKS DESIGN ASSOCIATED WITH THE CONSTRUCTION OF THE WORKS SHALL BE THE RESPONSIBILITY OF THE CONTRACTOR.
 10. THE CONTRACTOR SHALL MAINTAIN FREE AND OPEN ACCESS TO THE PUBLIC HIGHWAY AND ADJACENT LANDS AND PROPERTIES AT ALL TIMES UNLESS OTHERWISE AGREED IN WRITING WITH THE INTERESTED PARTIES AND LOCAL HIGHWAY AUTHORITY.
 11. CONTRACTOR TO LOCATE EXISTING SERVICES AND VERIFY POSITION OF EXISTING SERVICES AND VERIFY POSITIONS OF EXISTING APPARATUS PRIOR TO COMMENCEMENT OF WORKS.
 12. PRIOR TO THE START OF THE WORKS THE CONTRACTOR SHALL AGREE A REGIME OF FORMATION TESTING WITH THE ADOPTING AUTHORITY. THE FINDINGS OF SUCH TESTING (FOR EXAMPLE CBR READINGS) SHALL BE AGREED WITH THE ADOPTING AUTHORITY AND THE GAPPING / SUB-BASE DESIGN REVIEWED ACCORDINGLY.
 13. THE DIVERSION OF ANY PUBLIC SERVICES ARE TO BE UNDERTAKEN IN ACCORDANCE WITH THE REQUIREMENTS OF THE RELEVANT AUTHORITY/COMPANY.

A	For S38/278 Submission	01.03.2023
No.	Revision/Issue	Date

Firm Name and Address

Lvw

Highways

LwW Highways Ltd
Blawporth
Fellingwern Uchaf
Carmarthen
SA32 7PR
Tel: 01267 290769
Mbl: 07769 226695

Project Name and Address

Land at Gwelfor,
Heol Llanelli, Trimsaran,
Carmarthenshire.
Pavement, resurfacing &
Proposed Kerbs

Project	Sheet
2022-730	202
Date	Scale
02.03.2023	1:200@A1L

**PAVEMENT, RESURFACING & PROPOSED KERBS
 HIGHWAY LAYOUT DRAWING 1:200 @ A1L**

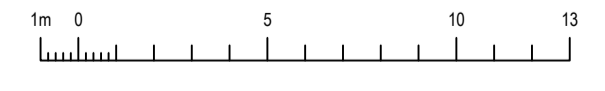

Site frontage, hedge, shrubs to be cleared within the visibility splays.
 No planting or walls over 900mm above existing road level.

730-202a - Pavement Resurfacing & Proposed Kerbs.dwg
 01.03.2023
 Karl von Weber