 Electricity Overhead Cables
 Existing Street light on wooden pole

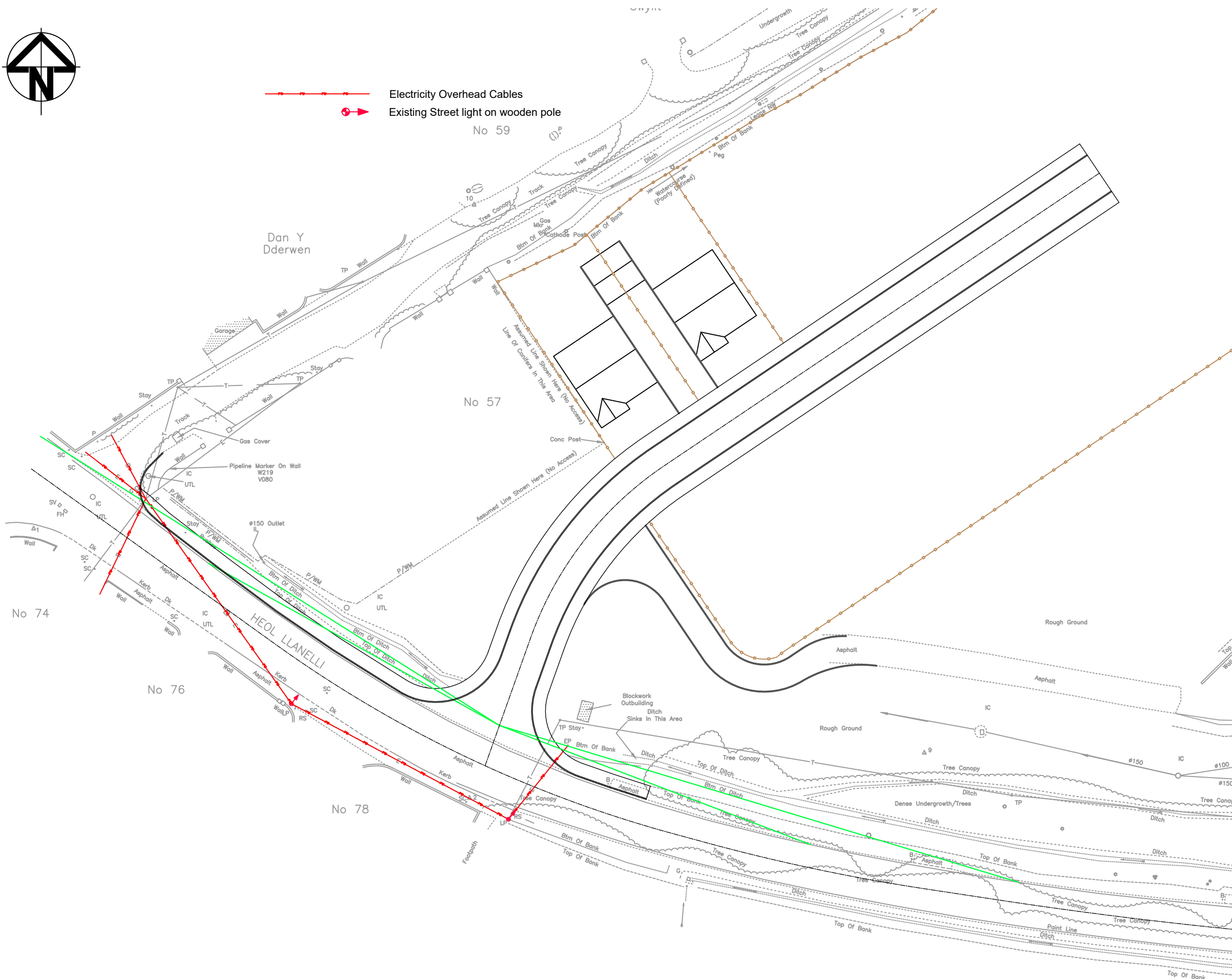

General Notes

1. ALL DIMENSIONS ARE INDICATIVE AND IN METRES UNLESS NOTED OTHERWISE.
2. DO NOT SCALE THIS DRAWING, USE FIGURED DIMENSIONS ONLY.
3. ALL LEVELS ARE IN METRES ABOVE ORDNANCE DATUM (AOD) BASED ON THE TOPOGRAPHICAL SURVEY DRAWING SUPPLIED BY THE CLIENT.
4. ANY DISCREPANCIES TO BE REPORTED TO THE ENGINEER.
5. THIS DRAWING IS TO BE READ IN CONJUNCTION WITH ALL OTHER RELEVANT ARCHITECTS AND ENGINEERS DRAWINGS AND SPECIFICATIONS.
6. THE SPECIFICATION IN ALL ASPECTS SHALL BE IN ACCORDANCE WITH THE CURRENT RESIDENTIAL DESIGN GUIDE AND SPECIFICATION IN FORCE WITHIN THE COUNTY AT THE TIME OF CONSTRUCTION.
7. COPYRIGHT OF THIS DRAWING IS RETAINED BY THE ENGINEER AND IT MUST NOT BE REPRODUCED IN WHOLE OR PART WITHOUT WRITTEN CONSENT.
8. Prior to construction works commencing on site, the locations and depths of all existing statutory undertakers and highway authority service equipment are to be checked and their locations confirmed. The removal, replacement, diversion, alterations of existing services/apparatus within the limits of the proposed works shall be undertaken by the contractor. All works shall be completed to the satisfaction of the relevant statutory undertakers in accordance with their specifications/requirements.

A	For S38/278 Submission	01.03.2023
No.	Revision/Issue	Date

Firm Name and Address

 LvW Highways Ltd
 Blaencarc
 Felinwern Uchaf
 Carmarthen
 SA32 7PR
 Tel: 01267 290769
 Mbl: 07769 226695

Project Name and Address

Land at Gwelfor,
 Heol Llanelli, Trimsaran,
 Carmarthenshire.
 Existing
 Street Lighting

Project	2022-730	Sheet	
Date	01.03.2023		801
Scale	1:500@A3		

EXISTING STREET LIGHTING LAYOUT 1:500 @A3L