

**Floor Areas:**

Total Gross Internal Ground Floor Area = 50.0.34m <sup>2</sup> (538.561sqft)
Total Gross Internal First Floor Area = 48.031m <sup>2</sup> (517.001sqft)
Total Gross Internal Area = 98.065m <sup>2</sup> (1055.562sqft)

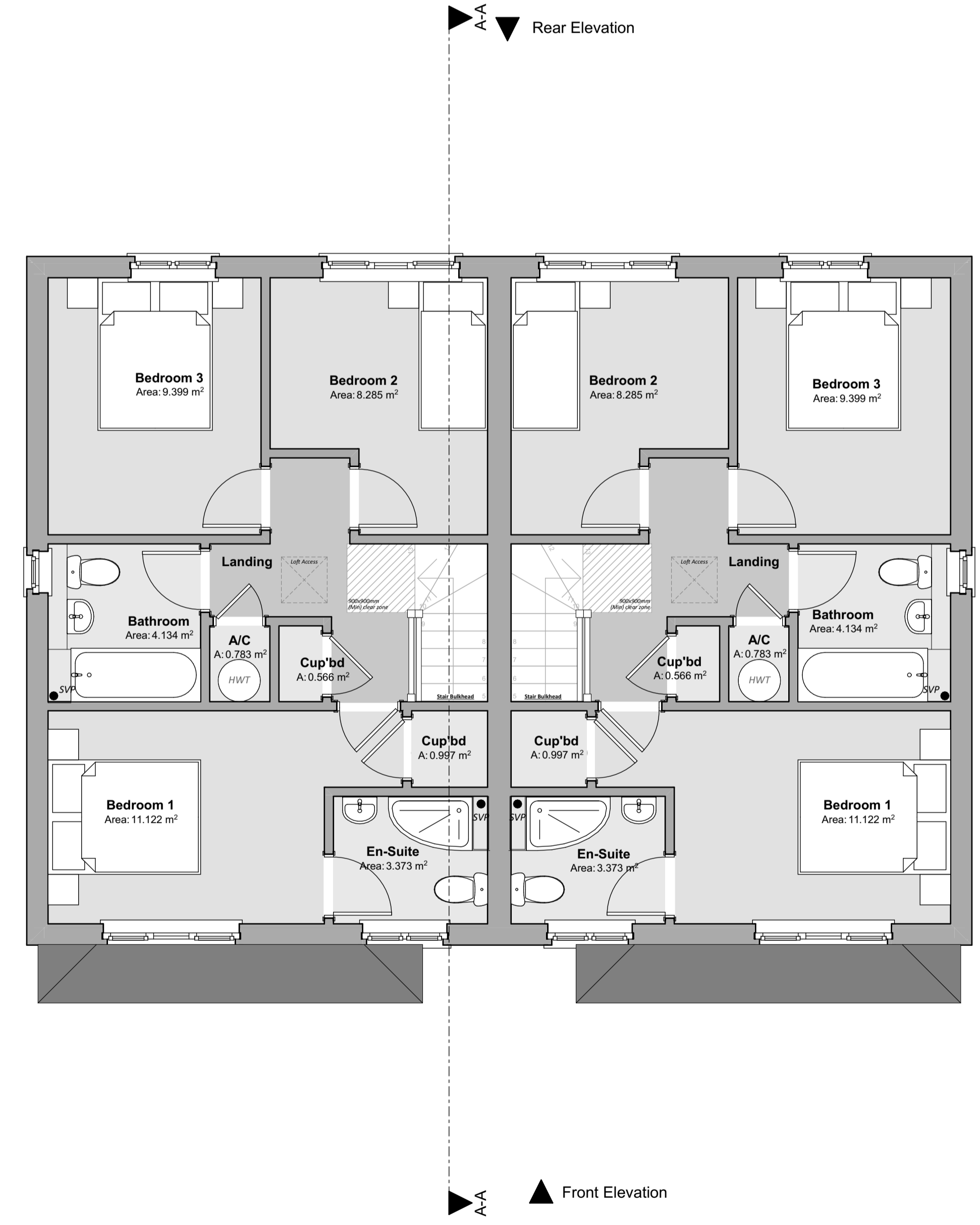

Revision:	Date:	By:	Notes:
Rev A - Layout updates following technical design review.	29th November '22	SP/MG	
REV B - General Updates	2nd Feb 2023	SE	

16 Main Street, Fishguard, Pembrokeshire, SA65 9JU  
01348 635004/06  
design@rlharchitectural.com  
www.rlharchitectural.com

Client: Morgan Construction Wales Ltd	Scale: Noted Date: July '22 Drawn: SE/RH	Drawing Title: PLANNING DRAWINGS - HTB V1 Semi-Detached House - Floor Plans, Elevations & Section
Job Title: Proposed Development, Land North of Whitlow, Saundersfoot, SA69 9AE		<b>R548 P-16-B</b>